

URBAN LAST-MILE INFRASTRUCTURE BY FOURMATIV

17,000 sq. ft of Ground-Level Urban Fulfilment Within 2.5 kms from 6 residential complexes, less than 2 km’s away from 3 commercial buildings.

Strategically positioned in Nerul, this **FOURUN hub** is designed to serve high-frequency urban distribution needs. Located 15 m from the main road and surrounded by established multi-storey residential developments, the site offers immediate proximity to end consumers. This enables faster dispatch cycles and reduced last-mile costs in one of Mumbai’s most supply-constrained urban pockets.

SITE LOCATION - <https://maps.app.goo.gl/2Kv9kJHBs1zFzWT68>

PROXIMITY HIGHLIGHTS

Location	Palm beach Residency	Millennium Towers Club House	Regency palms	Pushpa Niwas	Raheja Lunaris	Raheja Solaris (1200 units)	DY Patil Institute (~3,000 students)	Courtyard by Marriot (100 rooms)	Mindspace, Juinagar	Plan S Business Park
Distance from Site	2 kms	2.5 kms	2.4 kms	1.2 kms	2 kms	1.1 kms	500 m	700 m	1 km	2 kms

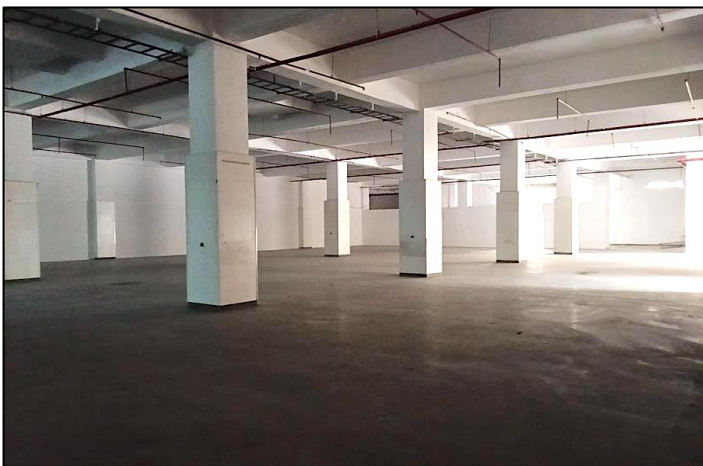

SITE LAYOUT

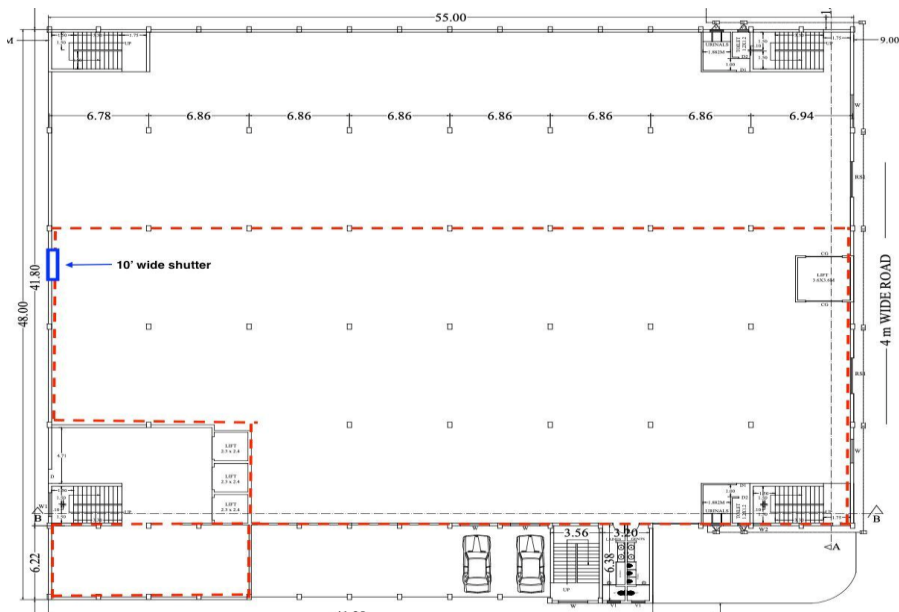

PROJECT OVERVIEW

SITE DETAILS

- Carpet Area: 17,000 Sq. ft
- Floor: Ground
- Shape: Rectangular
- Aspect Ratio: 1:03
- Ceiling Height: Below beam - 12 ft min

PARKING & LOGISTICS

- Parking Space: 1200 Sq. ft
- Parking Distance from Entry: 10 m
- Loading/Unloading Bays: 5
- Shutters: 5 shutters, 10 ft width each

CIVIL CONSTRUCTION

- Flooring: Kota flooring
- Walls: Brick wall partition
- Ceiling: RCC Structure
- Insulation: RCC structure, not required
- ODU Space (Cold Room Machines): Available
- Seating Area: On left side, provision can be made

ACCESS & FRONTAGE

- Front Width: 55 ft
- Entry/Exit Points: 6
- Street Width: 30 ft
- Distance from Main Road: 15 m

VALUE ADDED SERVICES

- Security Guard: Yes
- Housekeeping Staff: Yes
- Waste Management Services: Yes

UTILITIES & COMPLIANCE

- Power Availability: 3 phase power available
- Operating Hours: 24 hrs
- Staff Washroom (Onsite): Available
- Rider Washroom (External): Common washroom Available
- DG Space: Available
- Water Supply: 24-hours
- Fire NOC: Available
- Title Clearance: Clear
- Sanctioned Layout: Yes

THE COMPETITIVE EDGE



CUSTOMIZABLE & SCALABLE DEVELOPMENT

Customized fitment layouts

Modularized design framework



STREAMLINED COMPLIANCE

100% documentation and due diligence resolution



QUALITY ASSURANCE

Consistent development standards across locations



TIME-TO-MARKET INFRASTRUCTURE

Standardized infrastructure readiness

Rapid deployment capability

Flexible commercial structuring

THE FOURMATIV NETWORK

FOURUN is Fourmativ's urban last-mile platform designed as interoperable, operator-neutral infrastructure embedded within consumption clusters. Across Mumbai and the surrounding region, it operates at multiple strategic locations to ensure proximity, speed, and operational readiness for urban distribution.

Key Locations: WEH (Andheri), Kavesar (Thane), Marol, MIDC (Nerul), Sewri, Chandivali Naka, Kolshet (Thane), Near Taloja Toll, Near SEEPZ (Andheri E), Bhandup, Fort, Vikhroli, Malad, Thane, Chembur